

PARTS LIST			
ITEM	QTY	PART NUMBER	DESCRIPTION
1	1	01 000 339	SWITCH, LOW PRESSURE
2	1	01 000 340	SWITCH,HIGH PRESSURE
3	1	01 000 818	HARN, BLOWER 3 SPEED
4	18	02 000 045	WASHER, 3/16 SPLIT LOCK ZINC
5	1	02 000 056	GROMMET, 1/2" ID 5/8" OD
6	2	02 000 108	RIVET, SECONDARY HEAD
7	17	02 000 115	NUT, 10-24 HEX ZINC
8	18	02 000 163	SCREW,10-24 x 5/8 TYPE 23 THDCU
9	2	02 000 227	SCREW, 10 x 3/8 HEX WSHR TYPE A
10	18	02 000 585	NUT, COUPLING 8-32, 3/4 x 1/4
11	1	03 000 227	COIL, A/C 6 x 34.5
12	1	05 001 163	VALVE, EXP BLOCK 134a 2t W/SWP
13	1	06 001 769	BASE, MOUNT
14	1	06 001 770	BRACKET, BLOWER MOUNT
15	1	06 001 771	PLATE, SIDE - PS
16	1	06 001 772	PLATE, SIDE - DS
17	1	06 001 773	DRAIN, PAN
18	1	06 001 775	BRKT, COVER SUPPORT
19	1	06 001 780	PLATE, C/O BLOCK OFF
20	1	06 001 781	DRAIN PAN, PLATE C/O
21	2	08 000 008	O-RING, #8 13/32
22	3	11 000 156	BLOWER ASSY, 12v DBL SM W/SP RE

PART NO. 66 000 488

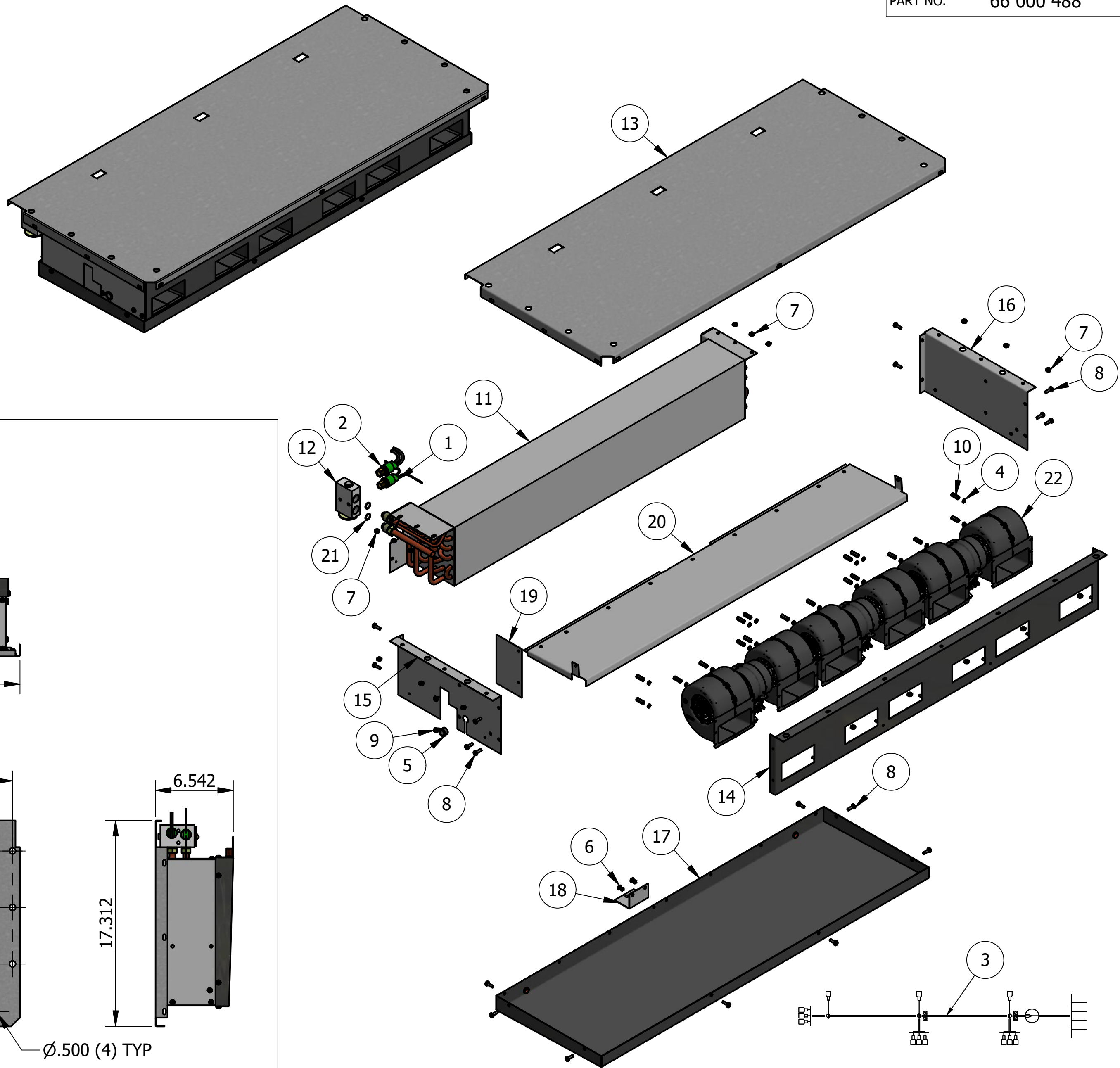

MOUNT INFO

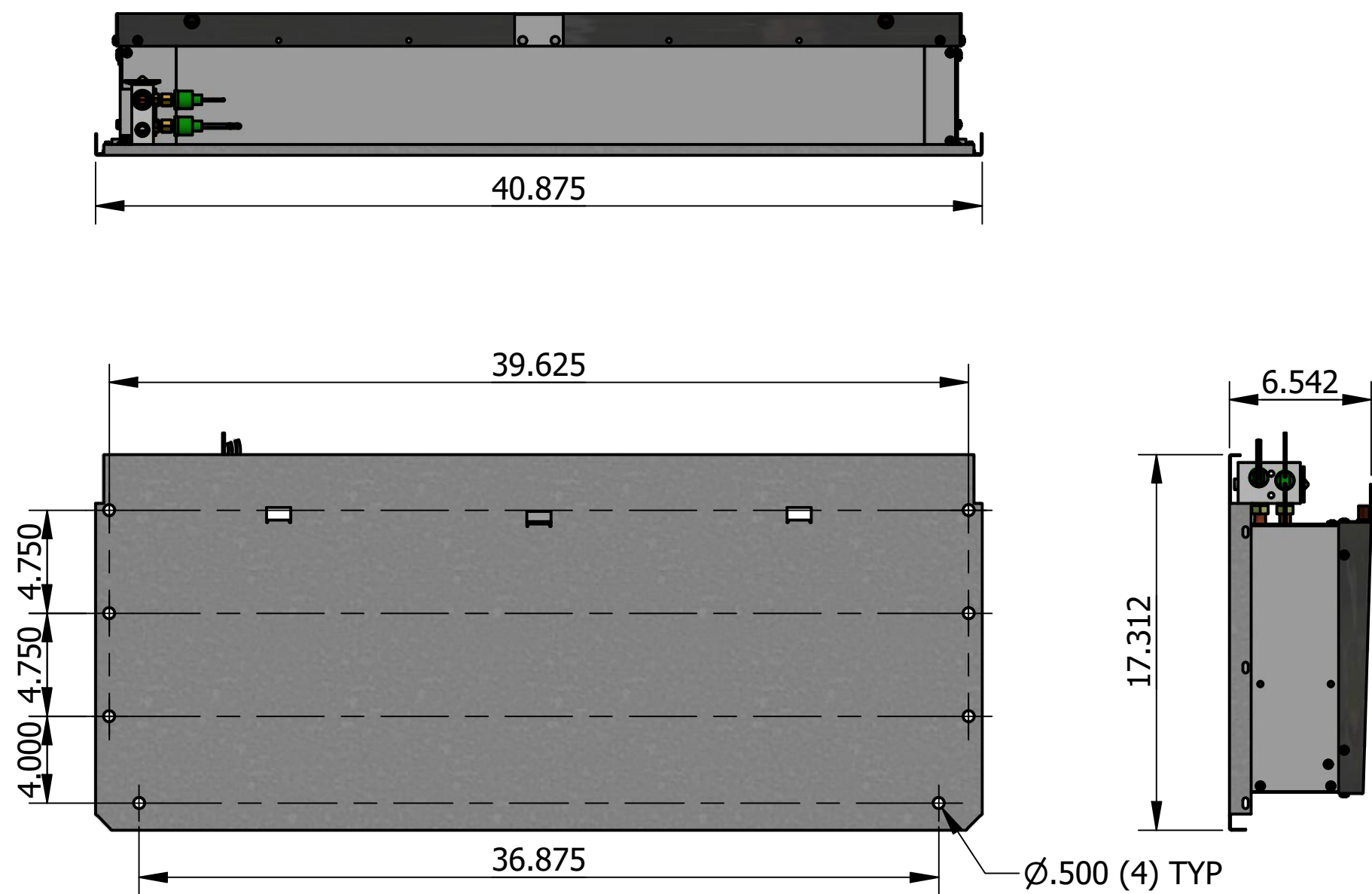

PROPRIETARY & CONFIDENTIAL. UNPUBLISHED WORK COPYRIGHT PRO AIR LLC. PRO AIR, LLC CLAIMS PROPRIETARY RIGHTS IN THE MATERIAL DISCLOSED HEREON. NEITHER THIS DRAWING NOR ANY REPRODUCTION OR PORTION THEREOF MAY BE DISTRIBUTED OR USED TO MANUFACTURE ANYTHING SHOWN HEREON WITHOUT PERMISSION IN WRITING FROM PROAIR, LLC.

REV. A

A	18-232	RELEASED TO PRODUCTION	CEB	10/17/18			TITLE:	PART NO. 66 000 488	
								FRIGIKING, 580 COOL ONLY	
LET.	NO.	REVISION	BY	DATE	APPROVED	2900 COUNTY RD 6 W ELKHART, IN 46514	USAGE:	SCALE: .15 : 1	SIZE A
							ALL	SHEET 1	OF 1